

# SCANIA PROREMOTE - USER MANUAL



## Content

1. MODEL OVERVIEW .....	2
2. INTRODUCTION .....	2
3. IN THE BOX.....	2
2. INTRODUCTION .....	2
3. IN THE BOX.....	3
4. INTENDED USE.....	3
5. CAUTIONARY REMARKS.....	3
6. TECHNICAL SPECIFICATIONS.....	5
7. PRODUCT ELEMENTS .....	5
Operation .....	6
Configuration .....	6
10. DISPOSAL.....	8
11. DECLARATION OF CONFORMITY.....	8

## 1. MODEL OVERVIEW

This user manual covers the following model/s of the vehicle load measuring units

Scania ProRemote

## 2. INTRODUCTION

Congratulations for purchasing this product! This user manual is intended to make you better aware of the suitable use, misuse and how to take care of your new Scania ProRemote.

Kindly ensure that this is read by a responsible adult that is capable of understanding the fundamental safety requirements called for the lifecycle of this product.

In any doubt, always request assistance from the manufacturer or listed distributor.

Ensure that all warnings and cautionary remarks are read and understood before using the device to make best use of this product.

**Retain manual and product packaging for future reference! Keep this manual in a safe place throughout the lifetime of the product and provide it to any other prospective user. Follow all instructions before use!**



## 3. IN THE BOX

Within the product packaging you are expected to find in un-altered condition the following components:

1x Handheld touchscreen device

1x Charging dock

1x Transmitter device

1x Antenna

1x Quick start Guide

1x Main cable

1x Charging dock cable

## 2. INTRODUCTION

Congratulations for purchasing this product! This user manual is intended to make you better aware of the suitable use, misuse and how to take care of your new Scania ProRemote.

Kindly ensure that this is read by a responsible adult that is capable of understanding the fundamental safety requirements called for the lifecycle of this product.

In any doubt, always request assistance from the manufacturer or listed distributor.

Ensure that all warnings and cautionary remarks are read and understood before using the device to make best use of this product.

**Retain manual and product packaging for future reference! Keep this manual in a safe place throughout the lifetime of the product and provide it to any other prospective user. Follow all instructions before use!**



### 3. IN THE BOX

Within the product packaging you are expected to find in un-altered condition the following components:

- 1x Handheld touchscreen device
- 1x Charging dock
- 1x Transmitter device
- 1x Antenna
- 1x Quick start Guide
- 1x Main cable
- 1x Charging dock cable

### 4. INTENDED USE

The intended purpose of the device is to facilitate the live weight carrying capacity of Scania trucks. The transmission device will relay information directly to the hand-held. The device is not intended to be used as an official measurement instrument, but only as an indicative scale to allow the user to understand what is being hauled. Thus the measurement shall not be referenced for any official documentation or to be replace any weighbridge device.

**Scania trucks specified with variant code 4909A or 4909B, are not compatible with the charging dock.** Either, place docking station elsewhere or use the enclosed USB-C cable for charging instead.

### 5. CAUTIONARY REMARKS

The user manual this will be accompanied throughout by various notations indicating the severity on the user, surrounding bystander or the environment of the indicated situation. These include:

#### **DANGER**

Danger indicates a hazard with a high level of risk which, if not avoided, will result in death or serious injury.

#### **WARNING**

Warning indicates a hazard with medium level of risk which, if not avoided, could result in death or serious injury.

#### **CAUTION**

Caution indicates a hazard with a low level of risk which, if not avoided, could result in minor or moderate injury

**⚠ DANGER**

- Product should not be used by children or people that have limited dexterity or level of cognition without the continuous assistance and instruction from a responsible adult
- DO NOT use within a potentially explosive environment or in the vicinity of large electromagnetic fields or rays as this will disrupt the signal and be of a potential ignition source
- Do not short-circuit the battery or the charging dock. This might result in overheating, fire or bursting the battery, leading to grievous consequences.
- Avoid hitting the handheld unit or exposing this to extreme high temperatures, which will risk of the battery leaking.
- In a possible instance, avoid contact with skin, eyes or exposed surfaces. In the rare circumstance or contacting battery acid, rinse thoroughly with clean water and attend to medical assistance at the earliest.
- DO NOT use the device whilst the vehicle is in motion or when the vehicle requires further attention to operate. Distractions from the primary vehicle responsibility may lead to injury, death or damage to the end user or 3<sup>rd</sup> parties. Use the device only when vehicle or other associated responsibilities are stationary or not in motion. Once set, the device will not require additional intervention or configuration to operate.



**⚠ WARNING**

- Keep all safety notices and instructions for future use! If the equipment is transferred to another owner, these instructions are to also accompany the product.
- This product may only be used by adults that fully understand the use of the product and its limitations.

**⚠ CAUTION**

- Recharge device only with the supplied docking station or with a USB-C cable suitable for fast charging; capable of handling at least 25W of power. Do not use other charging facilities. The port or contacts are to be ensured clean before inserting.
- Do not use a power washer to clean the transmission device. This should be cleaned with a damp cloth avoiding ingress to any port.
- Do not clean any of the devices with harsh solvents or chemicals. Cleaning the devices should be with a damp cloth.
- The device should not be thrown away in municipal waste stream at the end of life. This should be considered as WEEE and should be disposed of in the appropriate waste collection depot in your location. To ensure safety to all parties, the devices should be dismantled by the authorised dealer in order to ensure the electrical configuration is setup as originally intended.
- DO NOT attempt to service or temper the device. Request professional assistance from a competent technician. Doing so will void the warranty and lead to a possible risk of electrical hazard.
- Shipping and handling should be taken care of within the same containment this was initially shipped in. This must be used until the devices are located in their final use location.
- Installation and commissioning is to be only carried out by authorised resellers by the manufacturer!
- DO NOT attempt to fit this without prior authorisation. -Will void the warranty. Installation of receiver should be located where this is visible without effecting the end users ergonomics or will require additional effort to view the displayed data.
- Abide to install the correct fuse rating in order to protect the transmitter and receiver.
- In case of difficulty to make use or configure the device, always contact the installation centre or the manufacturer.



## 6. TECHNICAL SPECIFICATIONS

### Parameters

Model	Wireless weight indicator
Display size (mm)	49 x 72
Display resolution (px)	320 x 480
Screen brightness (nits)	1200
Operating voltage (V)	7 ... 60
Operating current (mA)	< 1000
Fuse rating (A)	2
Insulation class rating	III
IP rating - handheld device	IPX2
IP rating - transmission module	IP00
Operating temperature conditions (°C)	+5...+45
Operating humidity conditions (%rH)	5...95 (non-condensing)
Storage temperature conditions (°C)	+5...+50
Storage humidity conditions (%rH)	5...95 (non-condensing)
Weight - handheld device (g)	160
Weight - transmission module (g)	65
Battery type	LiPo (Lithium Polymer)
Charging time (approx.) (h)	3
Operating time (approx.) (h)	3 ... 4 (depending on brightness setting)

### Product dimensions

Hand held device:	112mm x 61mm x 24mm
Docking station:	130mm x 62mm x 54mm
Transmission module:	78mm x 54mm x 31mm



## 7. PRODUCT ELEMENTS

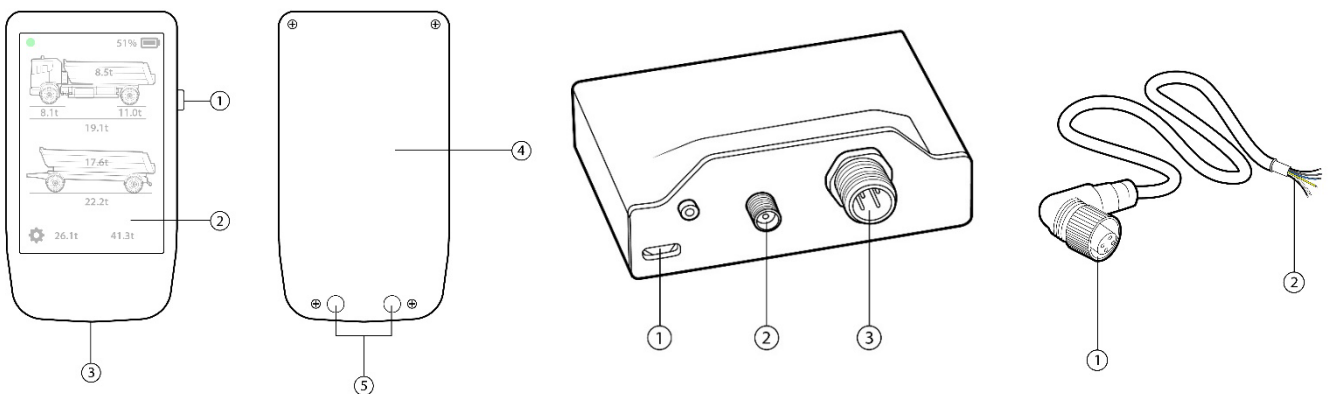

- 1 - Power button
- 2 - Screen
- 3 - USB-C charging port
- 4 - Magnetic back
- 5 - Charging points

- 1 - USB-C
- 2 - Antenna
- 3 - M12 connector

- 1 - Connector for the transmitter
- 2 - Connects to the truck

## 8. OPERATION INSTRUCTIONS

### Operation

The device can be controlled via the touch screen and the side button  
The side button will lock/unlock the device or change its power state

- Single press - lock
- Double press - unlock
- Press for 3 seconds - shuts off device or turns it on respectively.

Screen lock is accompanied with a 'lock symbol' in the top left corner

### Connectivity mark

The top left mark indicates the connectivity status;

- Red - Not connected to transmitting device
- Yellow - Connected to transmitting device, but not receiving information from truck
- Green (pulsing) - Connected and receiving information

The battery capacity is marked with the battery percentage indicator at the top right corner of the main screen

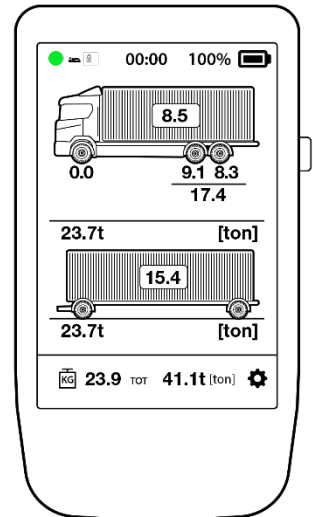

### Configuration



Settings menu from bottom left corner

Settings menu include:

- My truck
  - Axle configuration
  - Truck axle configuration
- Language
- Display
  - Calibrate touch screen
  - Display settings
- About this device
- Reset

Axle configuration includes the possible axle selection including;

- Tractor 2 axles, 4x2
- Tractor 3 axles, 6x4
- Tractor 4 axles, Tridem
- Truck 2 axles, 4x2
- Truck 3 axles, 6x4
- Truck 4 axles, Double steer boggle
- Truck 4 axles, Tridem
- Truck 5 axles, 10x4

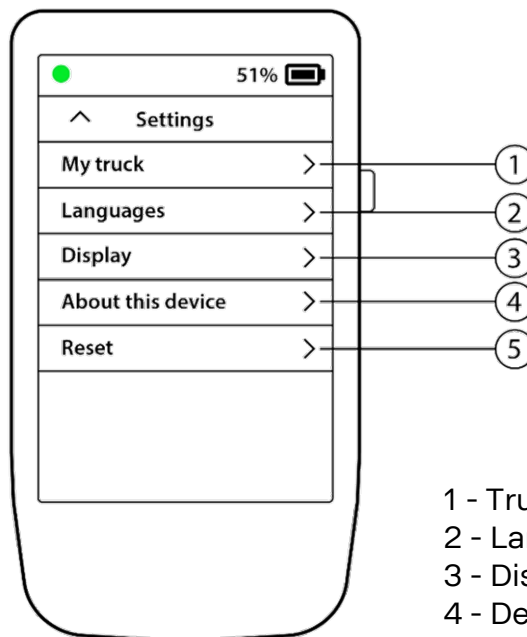

- 1 - Truck detail menu
- 2 - Language selection menu
- 3 - Display adjustment menu
- 4 - Device information menu
- 5 - Factory reset menu

Select the appropriate configuration. Once saved, You will automatically be sent back to the main screen.

You can always go back to the previous screen using the back button



Truck axle calibration will allow you to exactly fine tune the correct weight on each axle. This needs to be performed according to the weight measurement on the axle when measured by a separate source, such as a vehicle road testing station.

The arrows will assist the adjustment in increments of 0.1t (100kg). Saving these values will determine the unladen axle weight. You may have to reset the load weight after you have calibrated. This is done by clicking the “bucket” or the load weight on the truck/trailer. You will be prompted with a popup message that allows you to reset these values.

Language will allow the interchange of the display language to;

*Croatian, Czech, Danish, Dutch, English, Finnish, French, German, Hungarian, Italian, Lithuanian, Norwegian, Polish, Portuguese, Romanian, Slovak, Slovenian, Spanish, Swedish, Turkish.*

- Display settings screen will alter the brightness of the hand held device. This is controlled via the percentage bar.
- Automatic screen lock button allows for the possibility of locking the screen after a selected pre-set time. The screen will stay on and is still readable but clicking on it will be disabled.
- Screen calibration function allows for the calibration of the touch screen surface once pressing ‘Screen calibration’. Follow the instructions on the screen to calibrate it.
- About device menu, indicates the product serial number, firmware version and registered wireless address and password details.
- Reset screen will allow the possibility of resetting the complete unit to initial factory settings. **WARNING:** This will lead to losing any set information on the device, and will not be retrieved!

### Explanation of measuring nodes

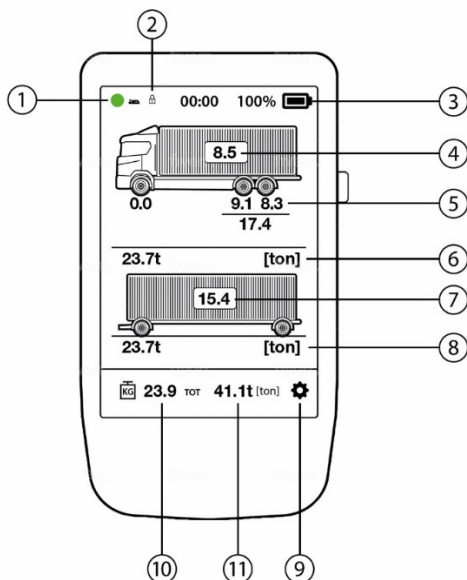

- 1 - Connectivity mark
- 2 - Touch glass locked
- 3 - Battery status
- 4 - Truck load weight / reset button
- 5 - Truck boggie weight
- 6 - Truck total weight
- 7 - Trailer load weight / reset button
- 8 - Trailer total weight
- 9 - Settings menu button
- 10 - Truck & Trailer load weight
- 11 - Truck & Trailer total weight

Tapping on the load weight will request to reset the load measurement

## 9. CARING FOR YOUR DEVICE

### General care instructions

- The device is a delicate piece of technology, meaning it is important to keep clean and dry
- Use a soft dry cloth to clean the dust and to dry and water on the device.
- Do not clean under running water
- Do not use harsh chemicals to clean the device

## 10. DISPOSAL

Dispose the device in accordance with waste electrical and electronic equipment regulation 2012/19/EU – WEEE (Waste Electrical and Electronic Equipment). Thus with a responsible manner and within your nearest WEEE acceptance facility

- Packaging should be recycled accordingly.
- Ensure that correct disposal requirements are met to preserve the environment.

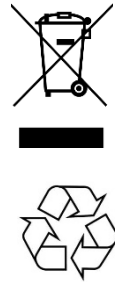

## 11. DECLARATION OF CONFORMITY

The EU declaration of conformity for this product have been supplied on the backside of the Quick Start Guide which came supplied inside the product box. Should you require a copy, please contact your local Scania workshop.

Manufactured in Sweden by

### **Oakhill Technologies AB**

Smedvägen 21  
SE 302 65 Halmstad  
Sweden  
info@oakhilltechnologies.se

Distributed by

### **Rindab AB**